

INSTALLATION INSTRUCTION

Volta 2" Tunable White - New Construction Square Housing

R2SNT, R2SNL



SAFETY INSTRUCTION

IMPORTANT: Never attempt any work without shutting off the electricity.

- Read all instructions before installing.
- System is intended for installation by a qualified electrician in accordance with the National Electrical Code and local regulations.
- Go to the main fuse box, or circuit breaker. Place the main power switch in the "OFF" position and unscrew the fuse(s) or switch "OFF" the circuit breaker switch(es) that control the power to the fixture or room that you are working on.
- Place the wall switch in the "OFF" position.

AVERTISSEMENT

IMPORTANT: Coupez l'électricité avant TOUTE manipulation.

- Lisez toutes les instructions avant d'installer.
- Système est destiné à être installé par un électricien qualifié en conformité avec le code national de l'électricité et les règlements locaux.
- Accédez au panneau central de disjoncteurs ou de fusibles de votre demeure et placez l'interrupteur principal en position d'arrêt (« OFF »).
- Placez l'interrupteur mural en position d'arrêt (« OFF »).

CAUTION:

All parts must be used as indicated in these instructions. Do not substitute any parts, leave parts out, or use any parts that are worn out or broken. Failure to follow this instruction could invalidate the ETL/cETL listing of this fixture.

OVERVIEW:

Housing is new construction. Housing requires a trim for a finished look. Refer to specification sheets for compatible trim options.

OVERALL HOUSING DIMENSION

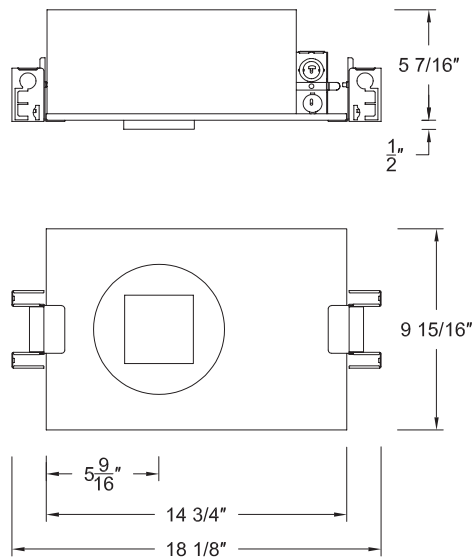

SPECIFICATIONS	
Input:	120-277V; 50/60 Hz
Installation:	Non-IC for -22 model (22W)
	IC for -15 model (15W)
Dimming	DMX for T-X model 0-10V for T-Z model

wacighting.com
Phone (800) 526.2588
Fax (800) 526.2585

Headquarters, East Manufacturing Facility
44 Harbor Park Drive
Port Washington, NY 11050

South East Manufacturing Facility
1600 Distribution Ct
Lithia Springs, GA 30122

Central Manufacturing Facility
1700 South J Elmer Freeway, Ste 100
Cedar Hill, TX 75104

West Manufacturing Facility
1750 S Archibald Ave
Ontario, CA 91761

INSTALLATION INSTRUCTION

Volta 2" Tunable White - New Construction Square Housing

R2SNT, R2SNL

WAC®

FIG. 1

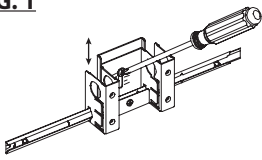

FIG. 2

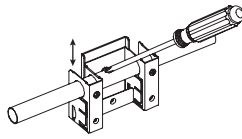

FIG. 3

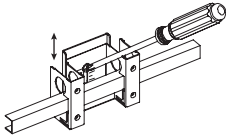

FIG. 4

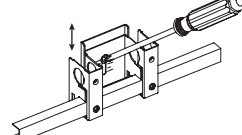

FIG. 5

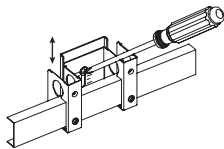

FIG. 6

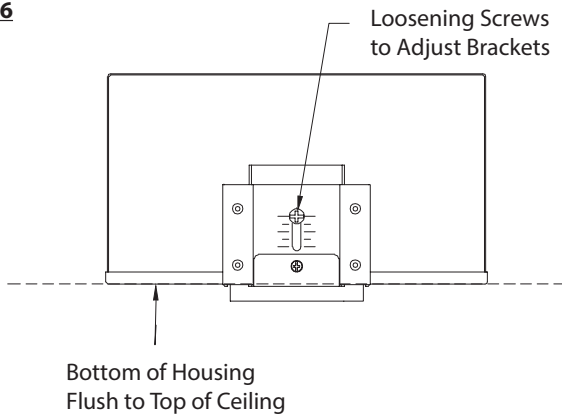
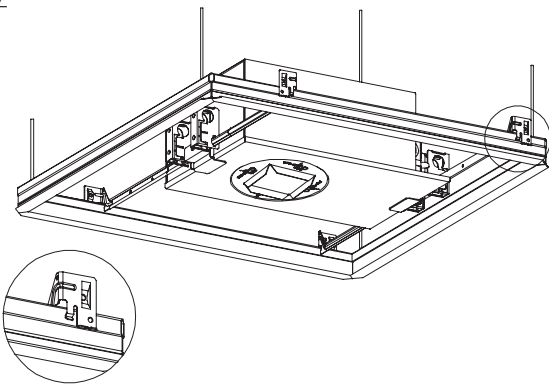

FIG. 7



HOUSING INSTALLATION:

1. Housing features mounting brackets that can be used with hanger bars or various channel supports (See **FIG. 1-5**).

Adjust the brackets to proper height by loosening the screws such that the bottom of housing is flush to top of finished ceiling plane (See **FIG. 6**). Retighten screws securely.

2. Slide the male and female hanger bars or other channel supports through the appropriate holes in the brackets.

3. A. For hanger bar installation on grid:

Hanger bars are notched on the ends to fit over "T" bars in the suspended ceilings supported with tie wires (by others) to upper ceiling structure (See **FIG. 7**).

INSTALLATION INSTRUCTION

Volta 2" Tunable White - New Construction Square Housing

R2SNT, R2SNL

WAC®

FIG. 8

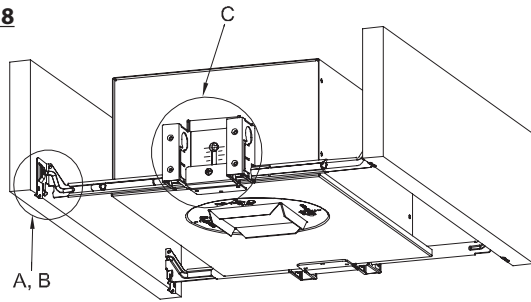

DETAIL. A

Hanger bar lip to rest on bottom surface of joist

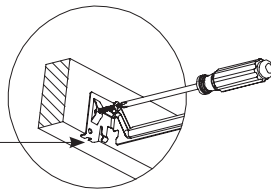

DETAIL. B

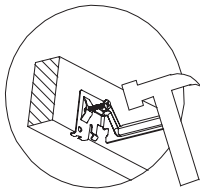

DETAIL. C

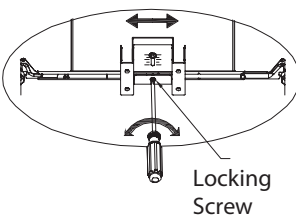

B. For hanger bar installation on joists:

Install the hanger bar and housing assembly such that the lip of the hanger bar rests on the bottom surface of the joist. Use a screw-driver or hammer to secure the "screw-nail" into the wood (See **FIG.8**).

- Slide the housing along the hanger bars to the desired position (See **Detail. C**). Tighten bottom locking screws to secure the housing in place.
- Connect fixture wires to building wires: insert each supply wire into appropriate connector.
- For 0-10V control [**T-Z** models] (See **FIG. 9**): Two 0-10V input signals are used to achieve CCT and intensity changing. Recommended maximum of 500ft of 18 ga 0-10V communication wiring.
 - For DMX control [**T-X** models] (See **FIG. 10**): Two DMX input channels are used to achieve CCT and intensity changing. Factory default Channel 1 is intensity changing and Channel 2 is CCT changing. If differing channels are desired in the field, use of a RDM compatible control console can reassign channels.

FIG. 9

**WAC
2CH 0-10V
Fixture**

Purple	0-10V(+) CCT Channel
Grey or Pink	0-10V(-) CCT Channel
Purple	0-10V(+) Dimming Channel
Grey or Pink	0-10V(-) Dimming Channel
Black	Line
White	Neutral
Green	Ground

FIG. 10

**WAC
DMX
Fixture**

Purple	DMX in (+)
Grey or Pink	DMX in (-)
Brown	Shield
Black	Line
White	Neutral
Green	Ground

It is recommended to use cable specifically designed for DMX. These cables have an impedance of 120Ω and a low capacitance. For instance: Belden 9841 or 3105a. At the last fixture, the cable to be terminated with a 120Ω resistor between the DMX (+) and DMX (-) pinouts to prevent reflections of the signal. The resistor value of the resistor on the last driver should be kept the same as the resistor of signal wires.

Recommended maximum of 500ft of cabling from controller to last fixture. After 32 unit loads a repeater/booster is recommended.

INSTALLATION INSTRUCTION

Volta 2" Tunable White - New Construction Square Housing

R2SNT, R2SNL

WAC®

FIG. 11

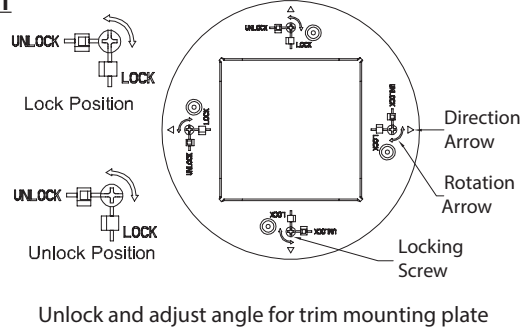

- Square trim mounting plate comes from factory aligned with housing. Should additional adjustments be necessary for field alignment, unlock 4 locking screws according to rotation arrows. Once free, align the square trim mounting plate. Direction arrows provide direction to assist with indexing. Relock mounting plate in desired position by locking screws according to rotation arrows. Once all locking screws are locked, review for confirmed stability (See **FIG. 11**).
- Cut a 3 9/16" x 3 9/16" square cutout in the ceiling at the point of installation and install ceiling (See **FIG. 12**). For invisible trims, cut a 4 1/4" x 4 1/4" square cutout in the ceiling (See **FIG. 13**).
- Refer to installation instructions for appropriate trims to complete the installation.

Note: Ceiling thickness table below.

TRIMMED INSTALLATION

Trim Model	Trim Description	Ceiling Thickness		
		1/2"	1"	1 1/2"
R2SD2T	<i>Downlight</i>	Yes	Yes	Yes
R2SD1T	<i>Shallow Regressed Trim</i>	Yes	Yes	Yes
R2SAT R2SPT	<i>Adjustable/ Pinhole</i>	Yes, to 45°	Yes, to 35°	Yes, to 20°
R2SWT	<i>Wall Wash</i>	Yes	Yes	No

INVISIBLE TRIM HOUSING INSTALLATION

- Repeat the same procedure as above from step 1 to step 7.
- Raise the invisible trim frame into trim mounting plate, and secure by using the screws supplied. Put plaster shield inside trim opening (See **FIG. 14**).

FIG. 12

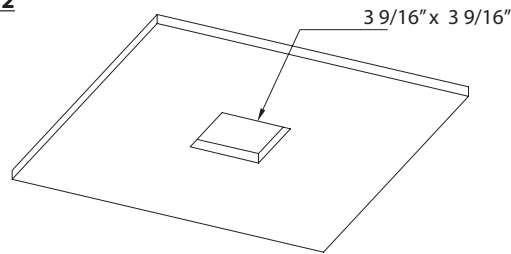

FIG. 13

Invisible Trim Housing

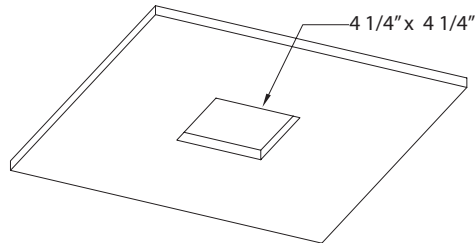
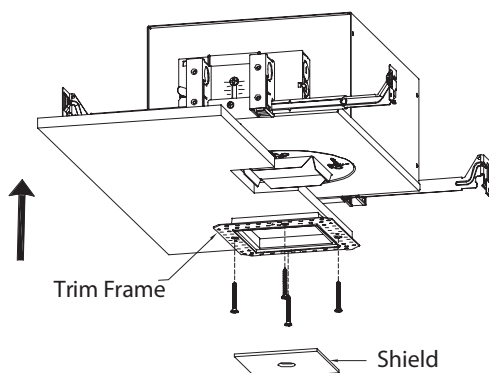

FIG. 14



INSTALLATION INSTRUCTION

Volta 2" Tunable White - New Construction Square Housing

R2SNT, R2SNL

WAC®

FIG. 15

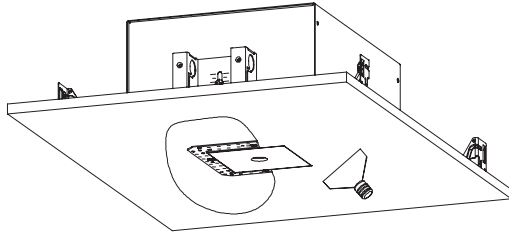
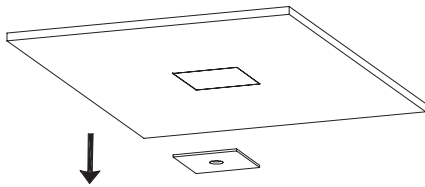

FIG. 16



3. Apply plaster or spackle over invisible trim and sand surface when dry for a finished look (See **FIG. 15**).
4. Remove the plaster shield when finishing is complete (See **FIG. 16**).
5. Refer to installation instructions for appropriate trims to complete the installation.

wacighting.com
Phone (800) 526.2588
Fax (800) 526.2585

Headquarters, East Manufacturing Facility
44 Harbor Park Drive
Port Washington, NY 11050

South East Manufacturing Facility
1600 Distribution Ct
Lithia Springs, GA 30122

Central Manufacturing Facility
1700 South J Elmer Freeway, Ste 100
Cedar Hill, TX 75104

West Manufacturing Facility
1750 S Archibald Ave
Ontario, CA 91761