

# AETHER 2" - Square Wall Wash Trimless

## R2ASWL



Fixture Type:

Catalog Number:

Project: \_\_\_\_\_

Location: \_\_\_\_\_

### PRODUCT DESCRIPTION

Shallow housing that is designed to fit in tight plenum spaces without sacrificing lumen output.

### FEATURES

- Designed to fit in tight plenum
- Wet location listed for trims
- 2" trim aperture, 2" housing height
- Universal input voltage (120V-277V)
- 5 year WAC Lighting product warranty

### SPECIFICATIONS

- Construction:** Die-cast aluminum trim with die-cast aluminum heat sink
- Dimming:** 100% - 5% with 0-10V  
100% - 5% with Electronic Low Voltage (ELV)/ TRIAC
- Input:** 120V-277V AC
- Power:** 15W, power factor 0.9
- Mounting:** Retention clips firmly hold trim to housing
- Finish:** Powder Coated White, Black, Black/White, Haze/White
- Ceiling thickness:** 1/2" - 1"
- Standards:** UL & cUL Wet Location Listed, Title 24 JA8 Compliant

Trim (See next page for housing)	Model	Beam	Color Temp	CRI	Lumens	Finishes
	<b>R2ASWL</b> Square, Wall Wash Lensed, Wet Location	A Asymmetrical	<b>827</b> 2700K	85	1000	<b>BK</b> Black <b>BKWT</b> Black/White <b>HZWT</b> Haze/White <b>WT</b> White
			<b>830</b> 3000K	85	1060	
			<b>835</b> 3500K	85	1085	
			<b>840</b> 4000K	85	1095	
			<b>927</b> 2700K	90	830	
			<b>930</b> 3000K	90	865	

**R2ASWL-** \_\_\_\_\_ **-** \_\_\_\_\_

Example: **R2ASWL-A930-WT**

Please see next page for housing (required)

# AETHER

## HR-2LED-H13A - Housing



Housing

Model

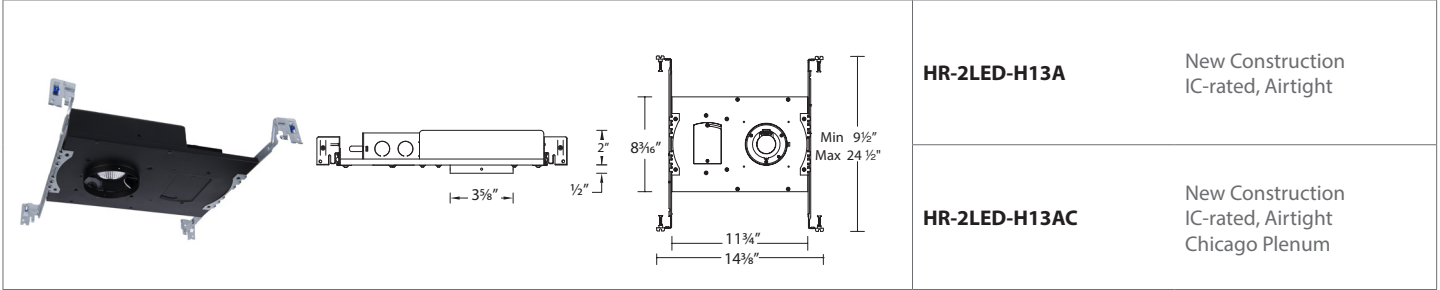

**HR-2LED-H13A**

New Construction  
IC-rated, Airtight

**HR-2LED-H13AC**

New Construction  
IC-rated, Airtight  
Chicago Plenum

### HR-2LED-H13 \_\_\_\_\_

Example: **HR-2LED-H13A**

wacighting.com

Phone (800) 526.2588

Fax (800) 526.2585

**Headquarters, East Manufacturing Facility**

44 Harbor Park Drive

Port Washington, NY 11050

**South East Manufacturing Facility**

1600 Distribution Ct

Lithia Springs, GA 30122

**Central Manufacturing Facility**

1700 South J Elmer Freeway, Ste 100

Cedar Hill, TX 75104

**West Manufacturing Facility**

1750 S Archibald Ave

Ontario, CA 91761