

INVISIBLE TRIM REMODEL HOUSING

2" Volta Tunable White

WAC®

SPECIFICATIONS

Input: Universal 120 - 277 VAC 50/60 Hz
Standards: ETL & cETL
Dimming: 2 Channel 0-10V: 100-0.1%
 2 Channel DMX512-A, with RDM: 100-0.1%
 Linear Dimming. 1st input channel is intensity changing.
 2nd input channel is CCT changing.
Mounting: Ceiling thickness ½ - 1"
 Ceiling cut out (Round): Ø 4¼"
 Ceiling cut out (Square): 4¼" x 4¼"
Construction: 20 Gauge cold rolled steel
 Diecast spackle flange included
Warranty: 5 year WAC Lighting product warranty

Fixture Type:

Catalog Number:

Project:

Location:

Round Remodel

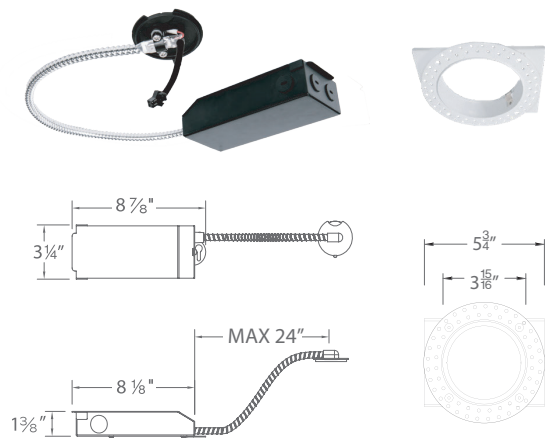

Square Remodel

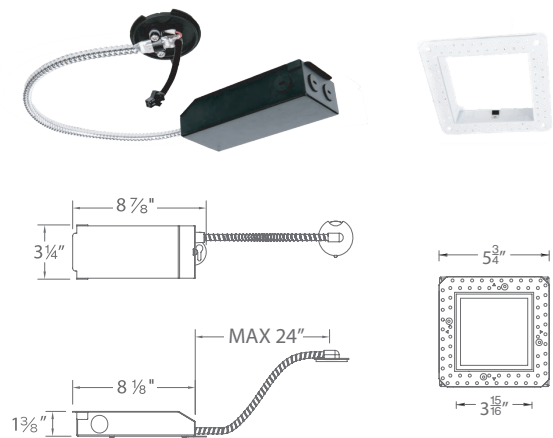

HOUSING (Required)	Model	Trim Type	Power	Driver
Remodel	R2RR Round	L Invisible Trim	15 15W	T-X DMX512-A
Non-IC	R2SR Square		22 22W	T-Z 2CH 0-10V

R2 ___ L- ___

Example: R2RRL-15T-X

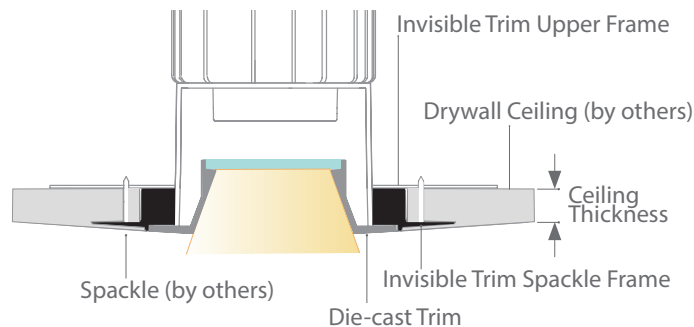

INVISIBLE TRIM™ INSTALLATION

Trim Model	Trim Description	Ceiling Thickness	
		½"	1"
R2RD2T R2SD2T	Downlight	Yes	Yes
R2RD1T R2SD1T	Shallow Regressed Downlight	Yes	Yes
R2RAT R2SAT R2RPT R2SPT	Adjustable/Pinhole	Yes, to 45°	Yes, to 35°
R2RWT R2SWT	Wall Wash	Yes	Yes

wacighting.com

Phone (800) 526.2588

Fax (800) 526.2585

Headquarters, East Manufacturing Facility

44 Harbor Park Drive

Port Washington, NY 11050

South East Manufacturing Facility

1600 Distribution Ct

Lithia Springs, GA 30122

Central Manufacturing Facility

1700 South J Elmer Freeway, Ste 100

Cedar Hill, TX 75104

West Manufacturing Facility

1750 S Archibald Ave

Ontario, CA 91761