

STEP LIGHT-277V

WL-LED201F

WAC®



Fixture Type:

Catalog Number:

Project: _____

Location: _____

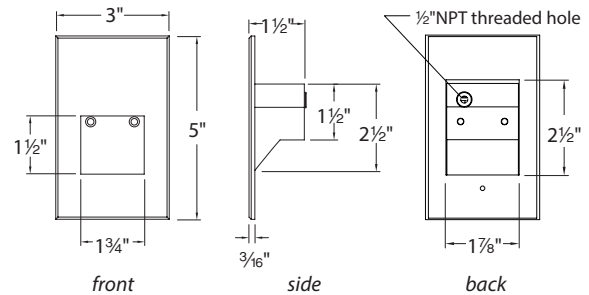

PRODUCT DESCRIPTION

With a sleek profile and no visible hardware, 277V Step and Wall Lights are designed to seamlessly blend into any architectural environment. These luminaires deliver enhanced energy efficiency and optimized light output to effectively illuminate stairs, walls, and walkways with little to no glare.

FEATURES

- Direct wiring, no driver needed
- Low profile, flush to wall aesthetics with no visible hardware
- IP66 rated, protected against high pressure water-jet
- 54,000 hour rated life
- Balanced lighting, free of shadows with minimum glare

SPECIFICATIONS

- Construction:** Die-cast aluminum
- Power:** Direct wiring, no remote driver needed.
Input voltage: 277V 50/60Hz
- Light Source:** Integrated LED Module, CRI 90+
Optional color lenses. Total power consumption of 3.5W
- Mounting:** Fits into 2" x 4" J-Box with minimum inside dimensions of 3"L x 2"W x 2"H
Includes bracket for J-Box mount.
- Dimming:** 100-10% ELV
- Standards:** IP66, ETL & cETL Listed for wet locations
Title 24 JA8-2016 Compliant.

ORDER NUMBER

| 277V | Color Temperature | Lumens | Finish |
|------------------------|---|--------|-----------------------------|
| WL-LED201F 277V | 30 AM White 3000K Amber 610nm | 65 | WT White on Aluminum |

*Brushed Nickel Finish is for interior use only



Example: **WL-LED201F-30-SS**

wacighting.com

Phone (800) 526.2588

Fax (800) 526.2585

Headquarters, East Manufacturing Facility

44 Harbor Park Drive

Port Washington, NY 11050

South East Manufacturing Facility

1600 Distribution Ct

Lithia Springs, GA 30122

Central Manufacturing Facility

1700 South J Elmer Freeway, Ste 100

Cedar Hill, TX 75104

West Manufacturing Facility

1750 S Archibald Ave

Ontario, CA 91761